

## User information

### REMI frontII-T

Ford Transit  
From production year 2000

Driver's cab blind system  
for Ford Transit

#### **Important!**

**Read this information carefully first.  
This system is not suitable for vehicles with  
airbags in the A pillars or above the doors!**

#### Contents:

- A. Product information
- B. Assembly information
- C. Operating information
- D. Repair and maintenance

### A. Product information

1. Manufacturer: REMIS GmbH  
Mathias-Brüggen-Str. 67-69  
D-50829 Köln
2. Designation and Type: REMIfrontII-T – Cab blind system, Ford Transit
3. Status, Date of manufacture: see sticker
4. Possible uses: Motor caravans based on the Ford Transit as from 2000 (vehicles without central electronic units on the instrument panel or airbags in the A pillar or above the doors)
5. Installation: see B. (Assembly information)
6. Function description: see C. (Operating information)
7. Variants: 2-part vertical blind system for front windscreen and vertical blind systems in frames for the side windows.  
  
High degree of shade through use of almost completely opaque pleated material.
8. Warning: The blinds may only be closed when the vehicle is stationary and the engine is switched off. Before starting the journey the system must be completely folded down and locked. Note, the handles can remain hot for long periods if exposed to strong sunlight.  
  
The system is not intended for shading the vehicle over long periods (e.g. over the winter). Depending on the temperature, the material may be temporarily more difficult to fold back.

### C. Assembly information

We recommend that the blind system is installed by a specialist workshop !  
 No liability or warranty is accepted in cases of incorrect assembly or installation.

#### Step 1: (Check scope of delivery)

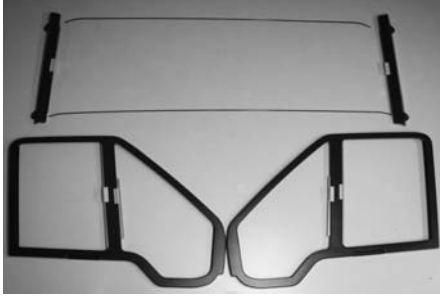

B1:  
 1 front system  
 Left and right cassette  
 Top guide tube  
 Bottom guide tube  
 1 side system, driver's side  
 1 side system, passenger side



B2:  
 1 tube holder with adhesive strip for top guide tube  
 1 tube holder for bottom guide tube  
 4 caps  
 4 screws LK3.9x32  
 4 screws SK4.2x13  
 12 screws LIK3.5x16  
 1 plastic strip

#### Step 2: (Assemble guide tubes, for trade only!)

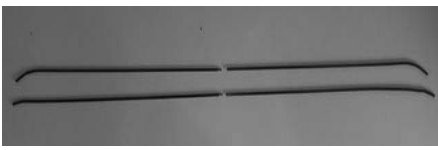

B3-B4:  
 If the top and bottom guide tubes are delivered separately, they must be joined with the adhesive supplied with the kit.



B5:  
 The adhesive is applied into the guide tube at the end without the thread. Use sufficient to fill the front part of the opening generously.

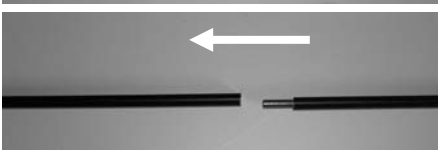

B6:  
 The guide tube with pin is now pushed rapidly into the other tube. Allow the joined tubes to harden for 10-15 minutes!

**Important:**

- i) Always link two of a pair!
- ii) The tubes should be laid on a flat surface and be aligned so that the bends point in the same direction (see B3).

#### Step 3: (Mount front system)



B7:  
 Remove cover from A pillar and if necessary push cables towards the centre of the cab. (This avoids screw damage!)



B8:  
 Align cassette on the left and right on the A-pillar cover, so that the screw lugs lie firmly against the rubber door seal.



B9:  
 The top lug must be in line with the A-pillar cover.



B10:  
 Bore holes into the A-pillar vertically to the cover surface at the markings (Ø2.5mm).



B11 & B12:  
 Screw the cassette left and right onto the 4 fixing points. (Screws LK3.9x32)

Accessories



B13:  
 Screw the carrier for the bottom guide tube to the middle of the instrument panel and screw on directly in front of the ventilation slits. (Screws SK4.2x13)

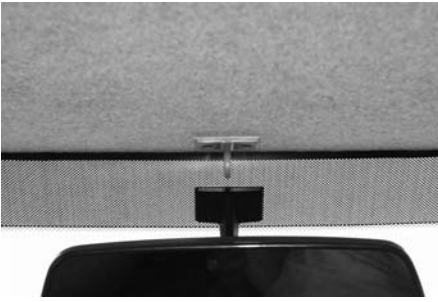

**B14:**  
Stick tube guide to the middle of the roof next to the mirror.

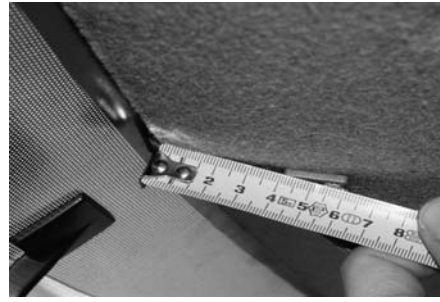

**B15:**  
NOTE! The distance between the edge of the roof and the edge of the carrier must be 40mm ± 2mm.



**B16:**  
Push plastic strip behind the roof covering.



**B17:**  
Hold plastic strip and carrier while screwing on. (Screws SK4.2x13)



**B18 & B19:**  
Push the bottom guide tube through the carrier on the instrument panel and fix with the screws in the left and right cassettes.



**B20 & B21:**  
Repeat procedure for top guide tube.



**B22:**  
Pull the blind closed. The gap between the blind and the instrument panel or the roof can be adjusted by rotating the fixing screws.



**B23:**  
Attach caps to left and right cassette.



**Step 4: (Mount side system)**



**B24:**  
Insert frame and press against door. Transfer the 6 drill holes to the door frame.



**B25:**  
Bore the holes which have been transferred into the door frame (Ø2.5 mm).



**B26:**  
Insert frame and screw. (Screws LIK3.5x16)

0

## C. Operating information

### Front system:

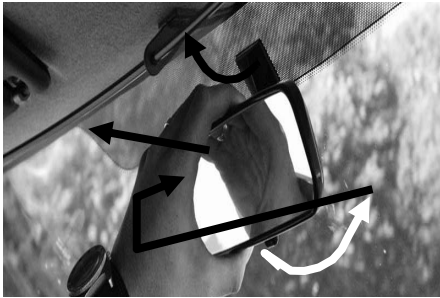

C1:  
Bend mirror back



C2:  
To open:  
Loosen handle from rest position by tilting and pulling lightly.  
To close:  
Latch in handle by pressing onto cassette.



C3:  
Bring handles together in the middle, magnetic catch locks blinds automatically.

### Side system:

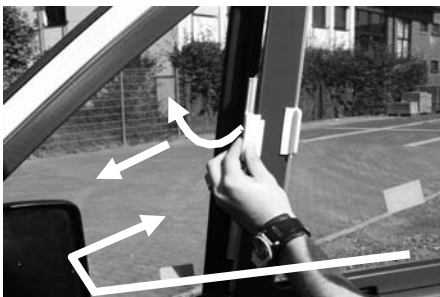

C4:  
To open:  
Loosen handle from rest position by tilting and pulling lightly.  
To close:  
Latch in handle by pressing onto cassette.



C5:  
Bring handle up to stop rail, magnetic catch locks automatically.

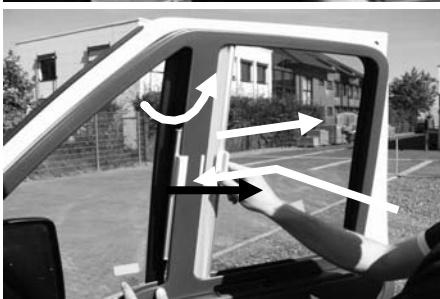

C6:  
To open:  
Loosen handle from rest position by tilting and pulling lightly.  
To close:  
Latch in handle by pressing onto cassette.



C7:  
Bring handle up to stop rail, magnetic catch locks automatically.

## D. Repair and Maintenance

1. Care: Do not use aggressive cleaners (solvents and abrasives). Clean the frame of the front and side system with a damp cloth and mild soap solution.  
Clean pleated material with a soft brush or a damp cloth.
2. Maintenance/repair: The system is designed to be maintenance-free.
3. Where to keep the documents: The user information with the operating and assembly instructions should be kept in the vehicle if possible so that they are at hand when needed.
4. Spare parts: Spare parts are available from your specialist dealer.

Information kindly supplied by Remis  
File converted to small PDF for easy  
download by motorcaravanning.co.uk